

Manchester Textile Market

Enjoy **ADVANTAGE** of prime location, matchless features & great price

Always stay ahead of the competition

: PROJECT BY :



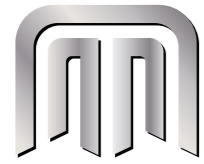

Manchester
Textile Market

Surat's Most Luxurious, Advanced & Functional Textile Market



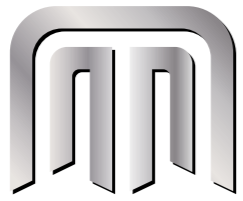

Manchester
Textile Market

ADVANTAGE Manchester

Prime Location

- ✓ Surrounded by Top 6 Textile Markets (Raghukul Textile Market, Millenium-2, HTC-1, Rajhans Textile Market, Millenium-3 & Avadh Textile Market)
- ✓ Adjoining Anjana Metro Station

Most Rewarding Purchase

- ✓ Ground & Upper Ground Shop clear slab to slab Height 20 ft. & 18.5 ft. Typical floor height so you get 2 shops space in 1 shop !!!

Grand Reception & internal Lobby Space

- ✓ Grand Reception Area of 40 ft. Height & 40 ft. width with escalator from ground to Upper ground
- ✓ Spacious internal Lobby offering Utility & Elegance through 12 ft. passage

Elegant Elevation & Façade

- ✓ Exposed Brickwork & RCC – Sophisticated & Timeless Look

Surat's Most Luxurious, Advanced & Functional Textile Market

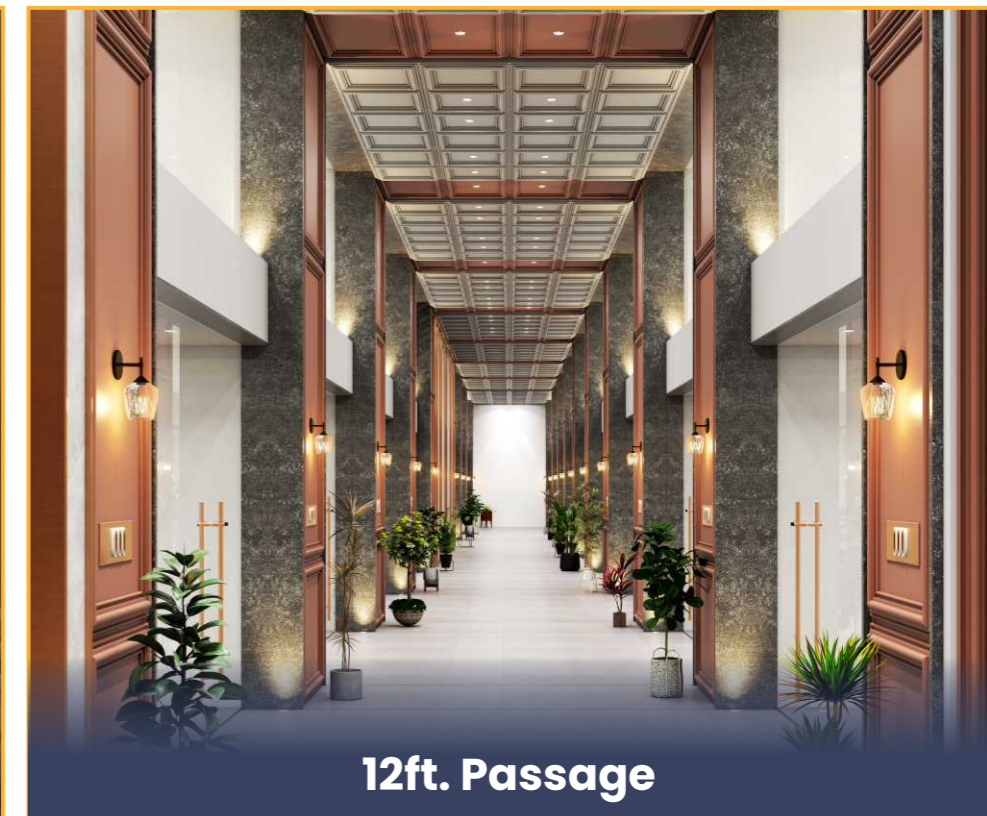

12ft. Passage

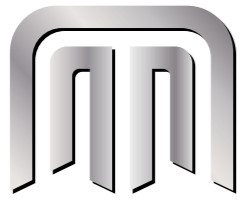

Manchester

Textile Market

ADVANTAGE Manchester

Highest Shop to Lift Ratio

- ✓ 30 Lifts For 30 Shops on a typical Floor! (1:1) ratio-highest yet in market history
- ✓ Accessibility of lifts from both basements with Trolley Facility for loading & unloading of goods

High-tech Basement

- ✓ 2 Basements, 1st & 2nd Basement Height-20ft. & 17ft. respectively.
- ✓ Easy entry & exit to both level basements for Trucks, Eicher & Goods Vehicles through 30 to 35ft. Ramp & 45ft. Turning Radius

More Advantages

- ✓ 925 ft. Project Front- Largest in its Class
- ✓ Ample Parking Space at Ground & both Basements Levels
- ✓ EV Charging Plug Points

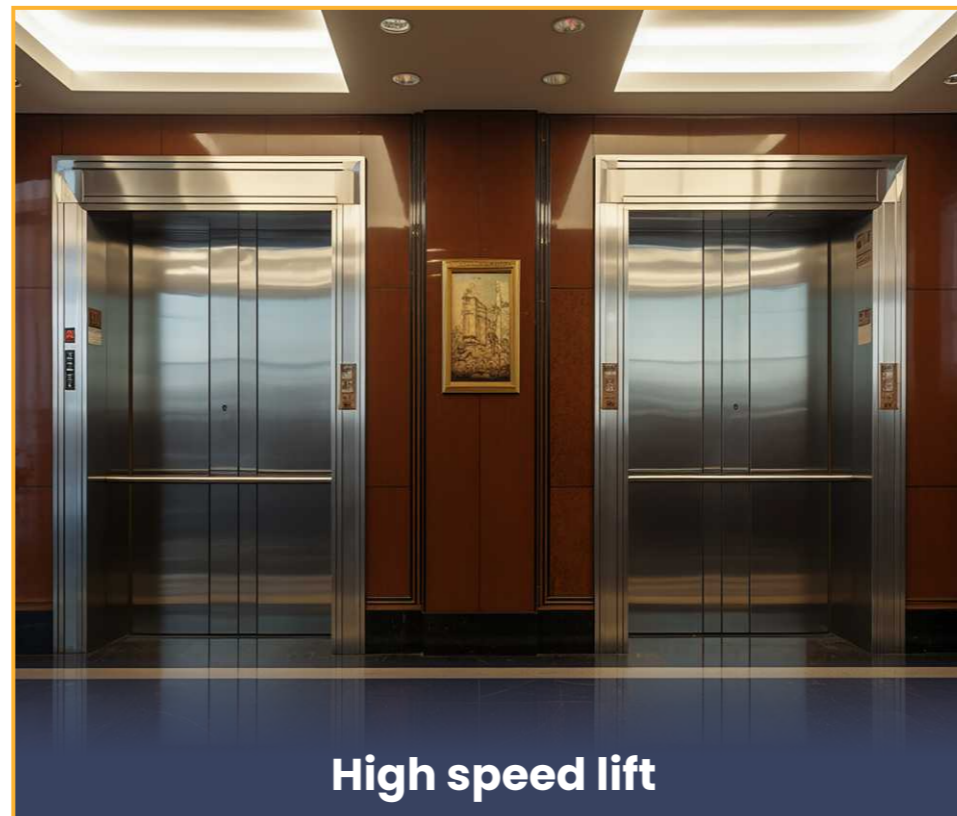

High speed lift



Basement Parking

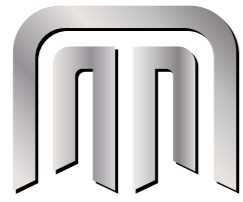

Manchester
Textile Market

ADVANTAGE Manchester

More Advantages

- ✓ Refreshment & Recreational Zone- for your food & relaxation needs when at work
- ✓ Audio/Visual Product Presentation Facility for showcasing your new products or to have business seminars & get-togethers
- ✓ RCC Frame structure for extra strength, durability & earthquake resistivity of the market for years to come.

Surat's Most Luxurious, Advanced & Functional Textile Market

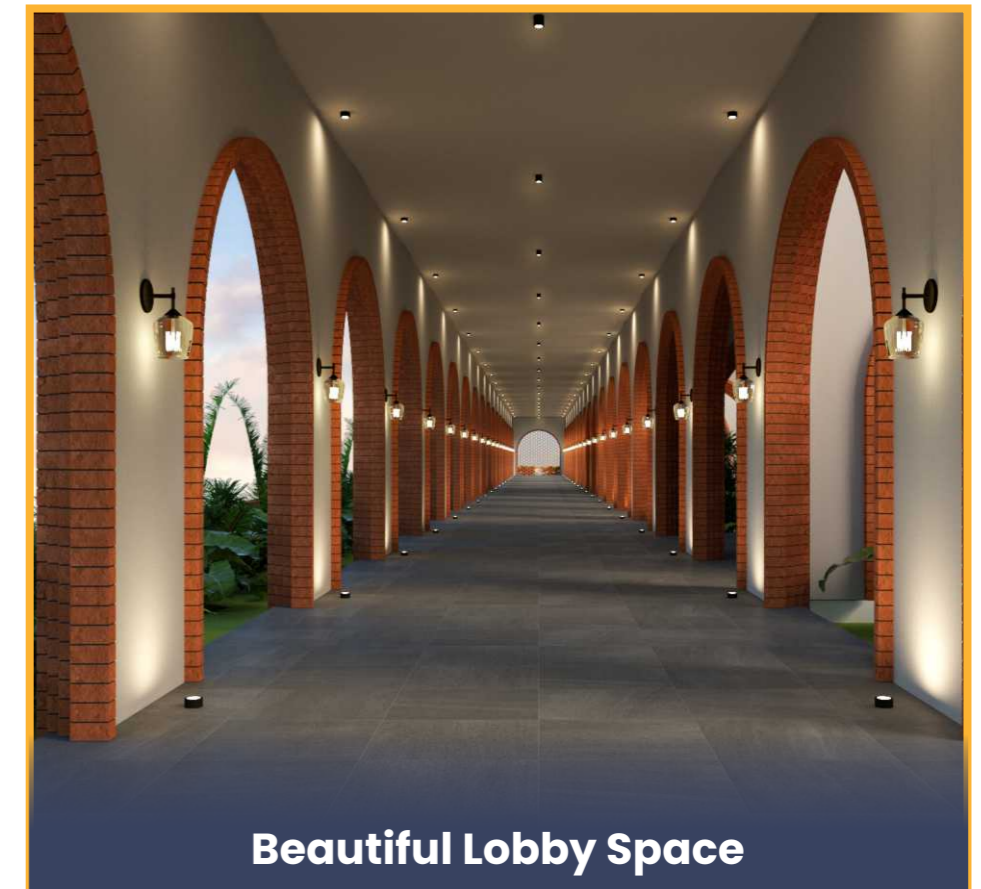
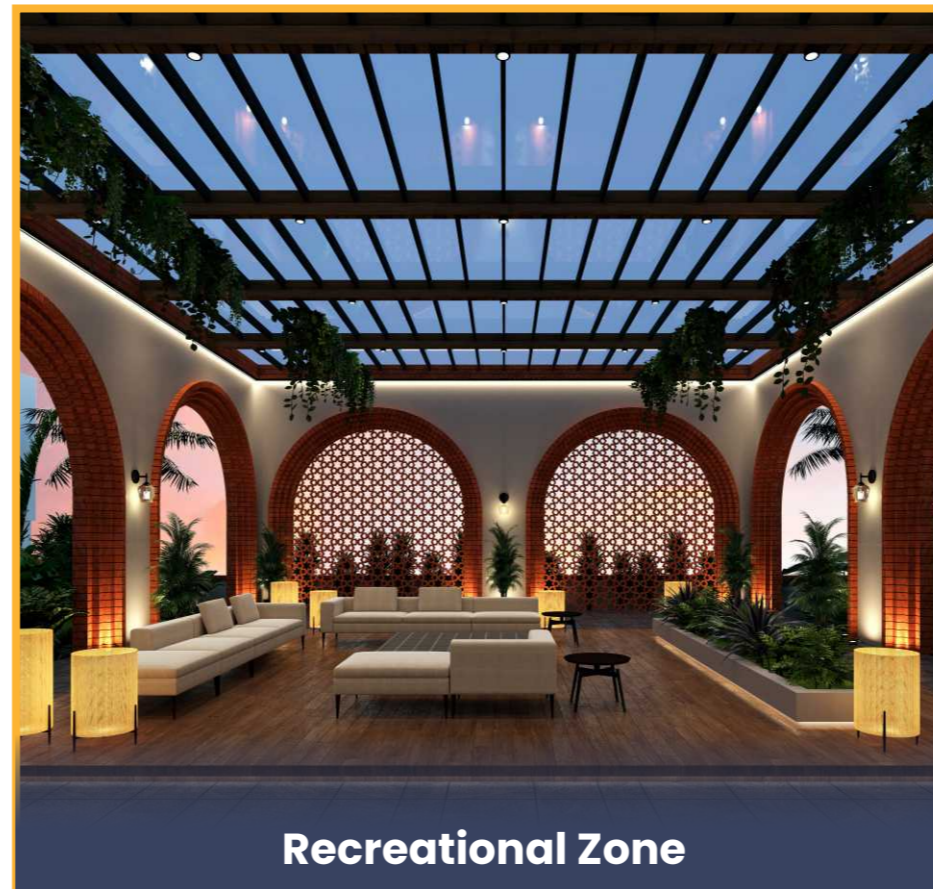
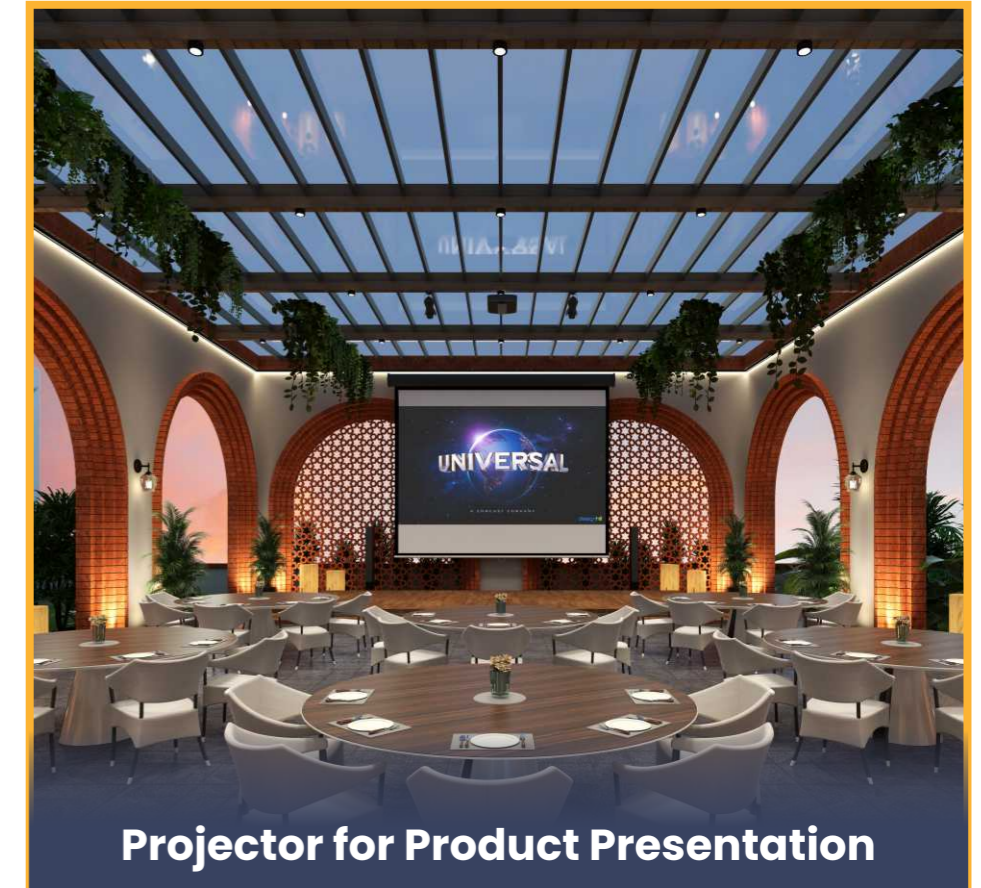
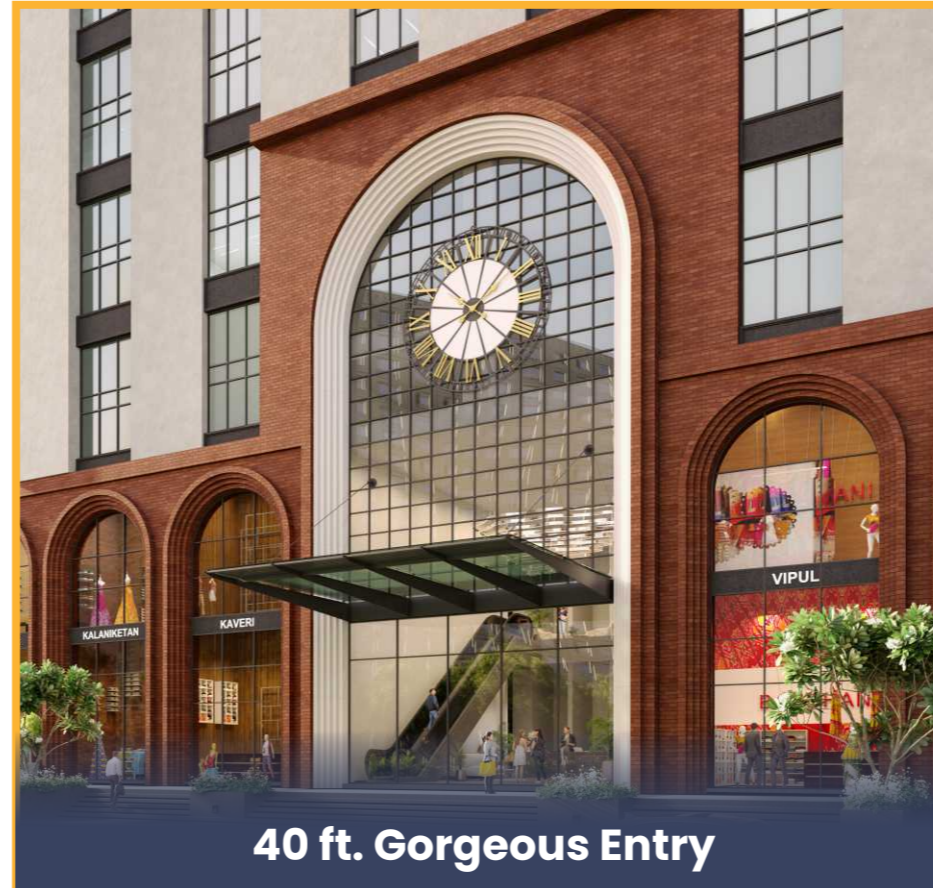

Upper Ground Floor Plan

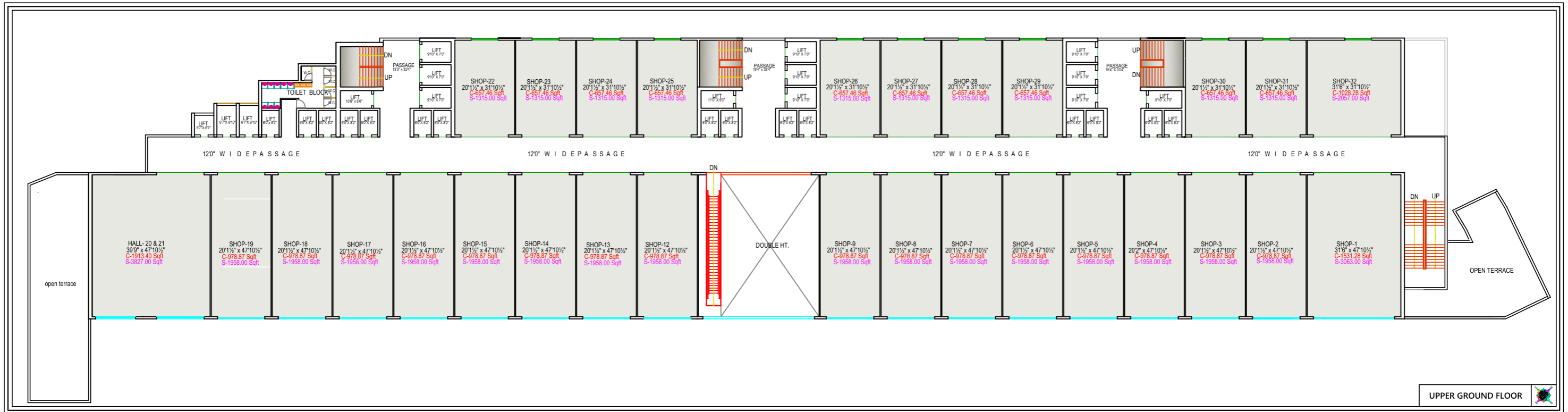

Ground Floor Plan

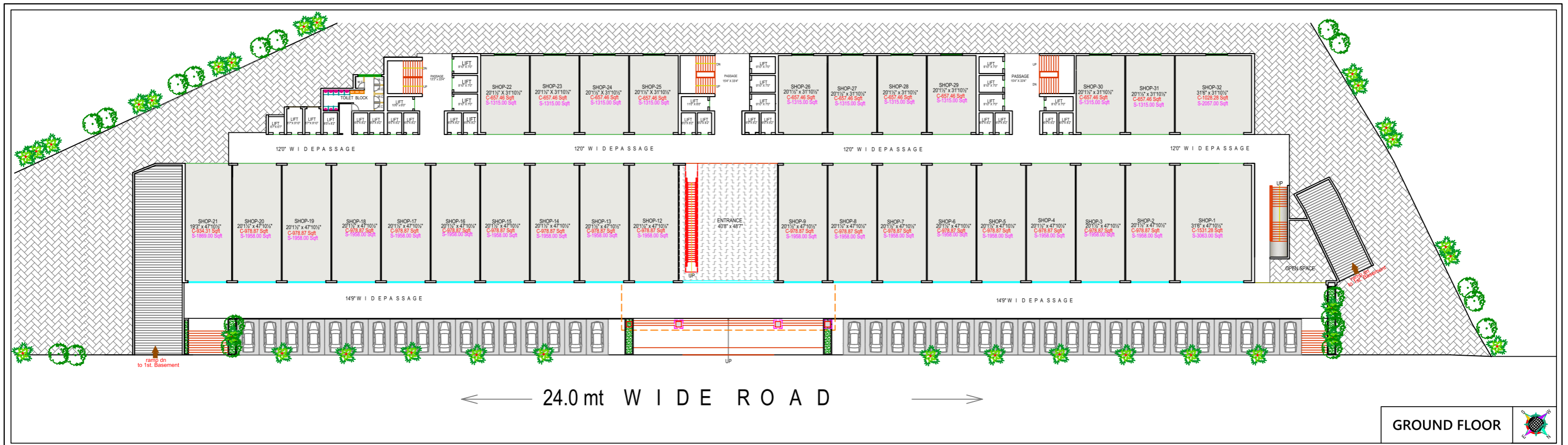

Typical Floor Plan (1st, 2nd & 3rd Floor)



Combo Floor Plan

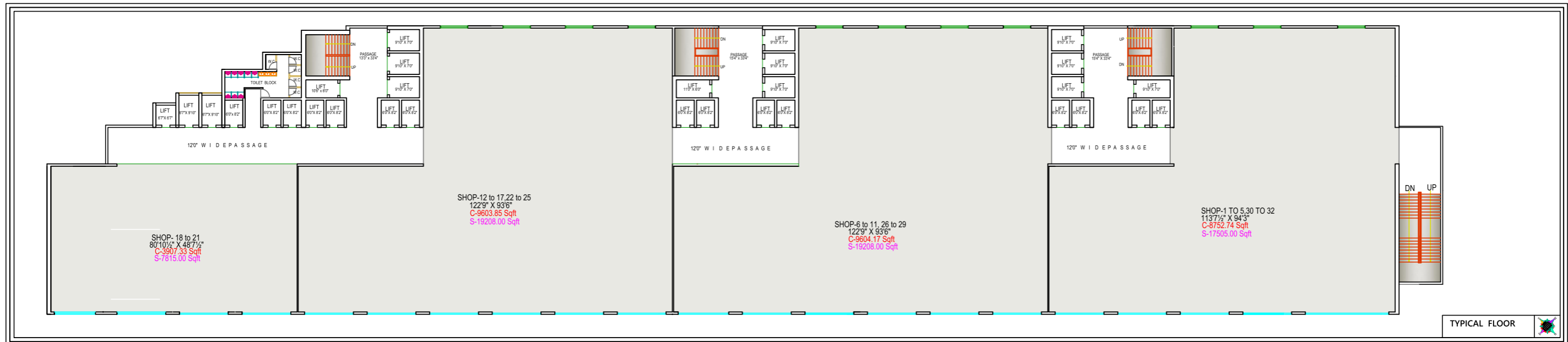

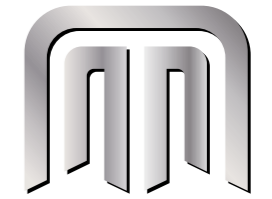

Manchester
Textile Market

Basement - 1 Floor Plan



BASEMENT-1



Basement - 2 Floor Plan

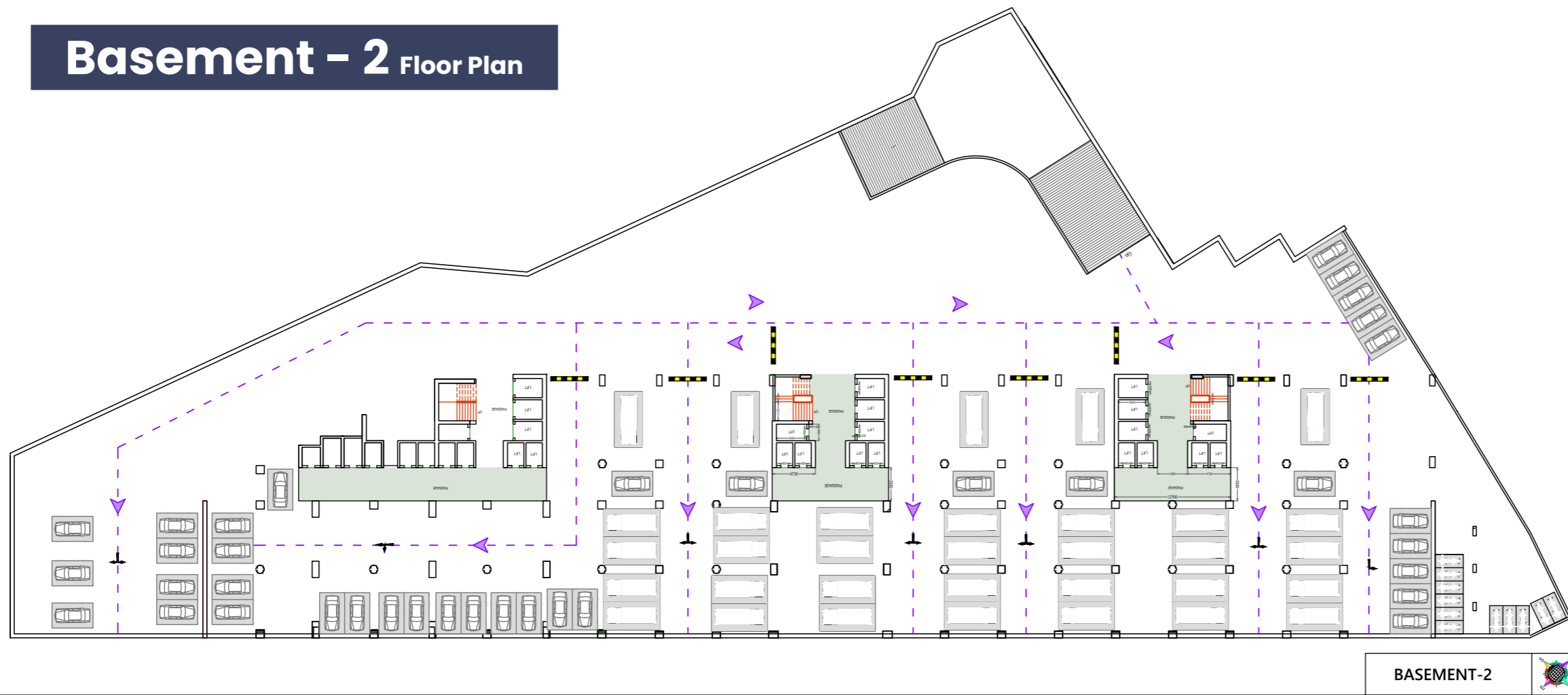

BASEMENT-2



Our Completed Projects

Commercial Projects

- Regent Textile Market- Ringroad
- Exult shoppers - Vesu
- Regent Arcade - Ghoddod road
- Exxoniic Mall- Jahangirpura
- Exiito Commercial Hub - Jahangirpura
- Exceluss Shoppers - Althan
- Regent Square - Adajan
- Shalby Hospital - Rander
- Exult shoppers - Vesu
- Regent Plaza - Dindoli
- Indralok - Chauta Pul

Residential Projects

- Samprati Palace- Vesu
- Siddhachal Residency - Adajan
- Kalp Residency - Kailash Nagar
- Sauryapuri Residency - Kailash Nagar
- Sparsh Residency - Kailash Nagar



Key Plan

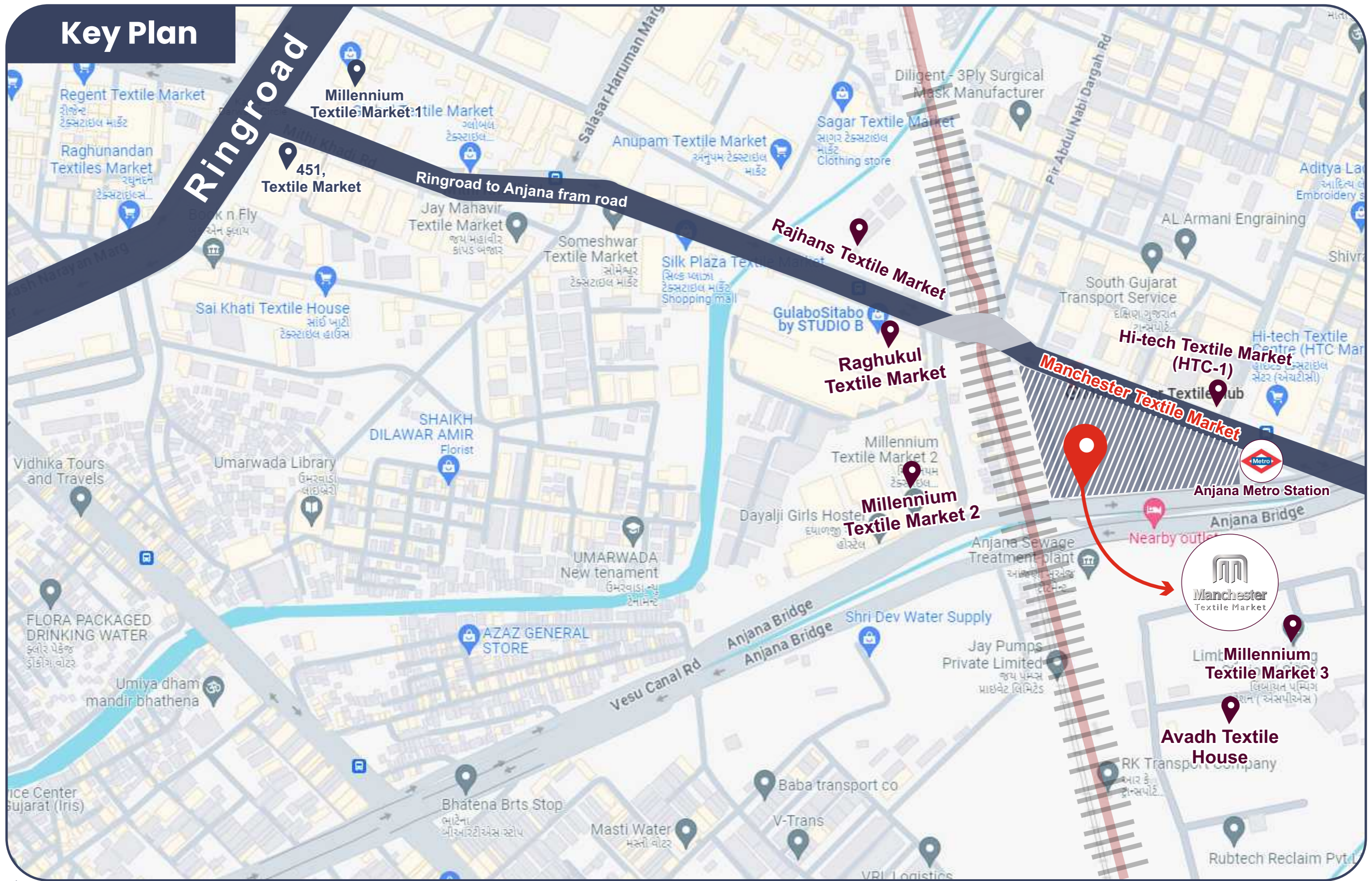

: Project by :



: ARCHITECT :

Mr. Hareshbhai Mahadevwala

(Aayojan Architects)

Renowned Architect of Gujarat having landmark projects to his credit

: STRUCTURAL CONSULTANT :

Er. Ranjith Chanduni (Mumbai)

(RECI Engineering Pvt. Ltd.)

(Expertise In Designing 55+ Storey Buildings & Work Exp In Singapore, Dubai & Mumbai)

: STRUCTURAL DESIGNER :

Er Jalil Sheikh

(Prominent and famous Structural Gujarat having completed esteemed projects)

: VASTU CONSULTANT :

Mr. Gurudatt Shenoy

(Expert vastu consultant of our country instrumental in guidance & well being of many clients/projects in india & abroad)

Enjoy **ADVANTAGE** of prime location, matchless features & great price

Contact Us

+91 99789 97856 | +91 99985 10095

mtmsurat@gmail.com

Ring-road to Anjana Farm road ,
Nr. Raghukul Textile Market, Surat

www.manchestertextilemarket.com